

Kit # 5600A-() - Temperature Compensation Upgrade Kit For UV-5A

EECO has developed a temperature compensation kit 5600A-() to upgrade standard S-series and earlier UV-5A valves currently in service. This upgrade provides **Full Temperature Compensation** over the valve's entire operational temperature range of 80° to 150° F (27° to 66° C). These changes will allow consistent elevator operation by maintaining floor-to-floor travel time and up leveling speed. EECO recommends that when a temperature compensation kit is installed in a valve, the rest of the seals in the rest of the valve also be replaced with high temperature Viton seals using EECO's standard seal kit 5131V. When ordering a temperature compensation kit and the 5131V seal kit, please have the existing valve size and/or serial number available.

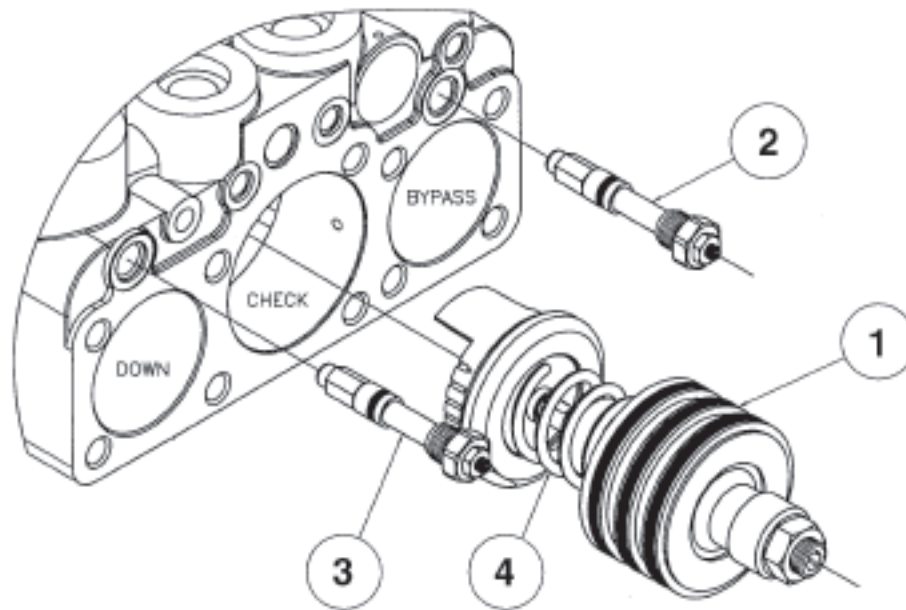

Upgrade Procedure

- 1) Close supply shut off valve to jack.
- 2) Relieve pressure in the valve by opening **Manual Lowering**.
- 3) Remove 6 bolts from UV-5A down/check flange.
- 4) Remove UV-5A down/check flange from the valve.
- 5) Remove UV-5A check piston assembly from the valve.
- 6) Insert provided UV-5AT check piston assembly into valve.
- 7) Remove DC adjuster from valve and replace it with provided UV-5AT DC adjuster (painted red).
- 8) Remove UA adjuster from valve and replace it with provided UV-5AT UA adjuster (painted green).

NOTE: It is strongly recommended that at this time the rest of the valve be rebuilt with seal kit 5131V, which contains high temperature Viton O-rings. To order this kit please contact EECO sales.

- 9) Replace down/check flange back into valve and replace and tighten bolts.
- 10) Close manual lowering and open supply shut off valve.
- 11) Refer to the UV-5AT "Adjustment Procedure" to readjust the valve.

NOTE: The optimum oil temperature range for adjusting the valve is 80° F to 100° F (27° to 38° C).

Kit Part Number & Sizes

ASSEMBLY NO.	SIZE
5600A-0*	1/16
5600A-1	1/8
5600A-2	1/4
5600A-3	1/2
5600A-4	3/4
5600A-5	1
5600A-6	1 1/4
5600A-7*	1 1/2

* Old "S Series" (or earlier) Valves.

Parts Included With Kit 5600A-()

ITEM	QTY.	PART NO.	DESCRIPTION
1	1	5601A-TAB	CHECK CLOSURE ASSEMBLY
2	1	5604A	UA ADJUSTER ASSEMBLY
3	1	5606A	DC ADJUSTER ASSEMBLY
4	1	5018	CHECK SPRING