

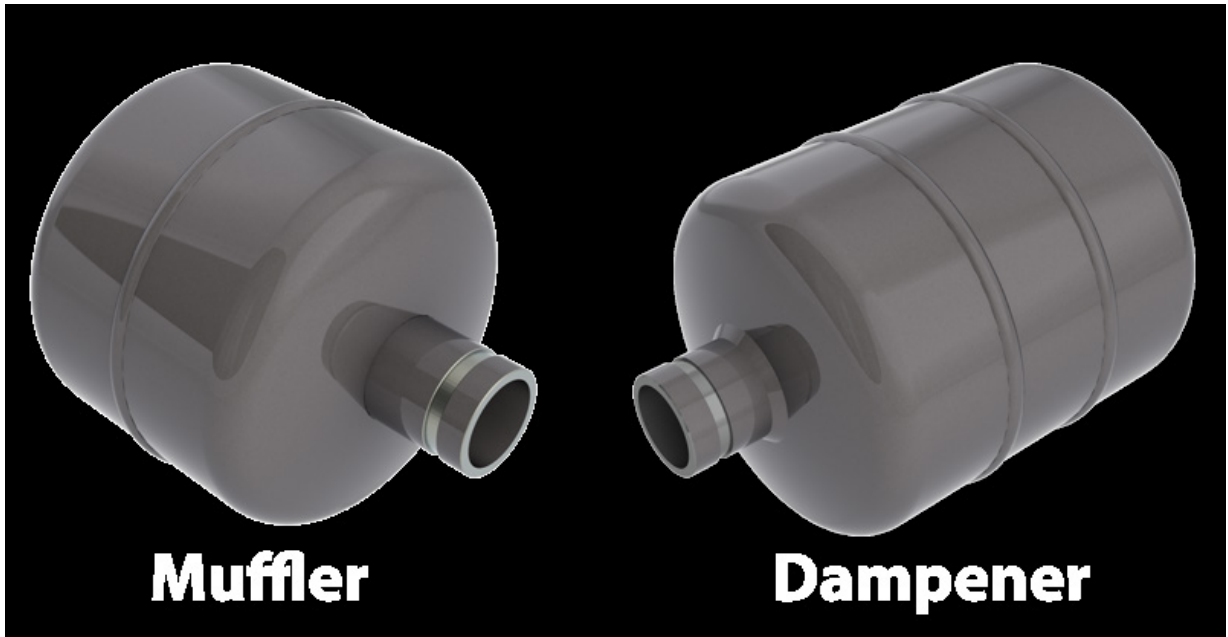

Elevator Equipment Corporation

"Simplicity in Motion"

Mufflers and Dampeners



Muffler

Dampener

EECO Hydraulic Muffler

The Muffler (MU) provides superior noise suppression for most standard power unit installations. The unit working pressure is 1200 psi and it is 11-3/4" long. The diameter for 2" outlet size is 6-5/8" and 8-5/8" for other sizes.

EECO Hydraulic Dampener

The Hydraulic Dampener (EHD) is extremely effective in suppressing the sound and pulsation present in hydraulic elevator systems. The EHD has a minimum burst pressure of 6000 psi with an ASME A17.1/CSA B44 allowable working pressure of 1200 psi. The diameter is 8-5/8" and is 14" long for the 2" outlet size and 14-1/2" for other sizes.

[More Info](#)

[Contact Us](#)



Come join us at Elevator U 2015 June 23-25 at Ohio State University. For more information, [Click Here.](#)